





Asus ZB501KL User Manual



1  
2

--

•

Bookmarks

--

[Download this manual](#)

### Quick Links

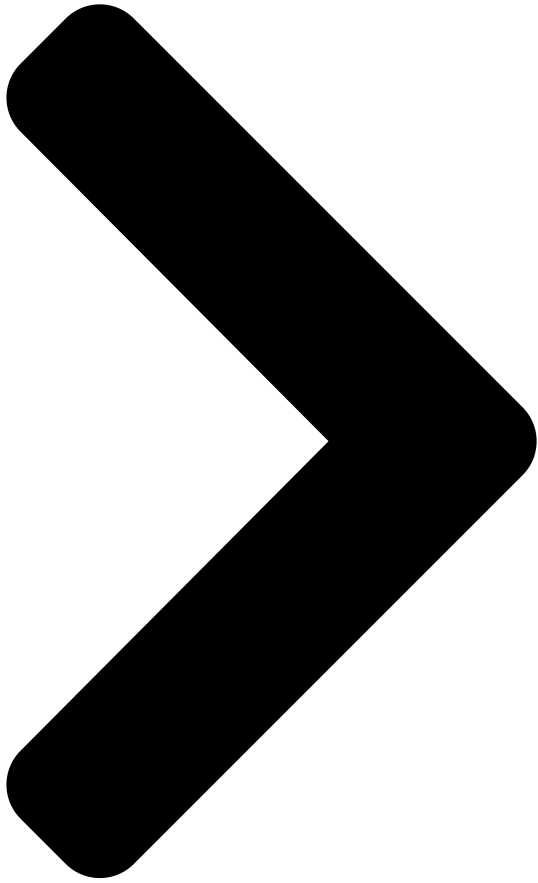

Enlarged version



User Guide

15060-92010000

E12261

Charging your ASUS Phone

To charge your ASUS Phone:

1. Connect the USB connector into the power adapter's USB port.
2. Connect the other end of the micro USB cable to your ASUS Phone.
3. Plug the power adapter into a wall socket.

IMPORTANT:  
User Guide

When using your ASUS Phone while it is plugged to a power outlet, the grounded power outlet must be near to the unit and easily accessible.

When charging your ASUS Phone through your computer, ensure that you plug the USB cable to your computer's USB 2.0 port.

Avoid charging your ASUS Phone in an environment with ambient temperature of

above 35°C (95°F).

NOTES:

For safety purposes, use ONLY the bundled power adapter and cable to avoid damaging your device and prevent the risk of injury.

For safety purposes, use ONLY the bundled power adapter and cable to charge your ASUS Phone.

The input voltage range between the wall outlet and this adapter is AC 100V - 240V. The output voltage of the micro USB cable is +5.2V 1A, 5.2W.

First Edition/ January 2017

Model: ASUS\_A007 (ZB501KL)

Before you start, ensure that you have read all the safety information and operating instructions in this User Guide to prevent injury or damage to your device.

NOTE: For the latest updates and more detailed information, please visit [www.asus.com](http://www.asus.com).

Front features

- LED indicator
- Camera Flash
- Proximity sensor and light sensor
- Front camera
- Receiver
- Touch screen display
- Touch keys

Installing a Nano SIM /MicroSD card

To install a Nano SIM / MicroSD card:

1. Push a pin into the hole on the Nano SIM / MicroSD card tray.

IMPORTANT:

2. Insert the Nano SIM or MicroSD card(s) into the card slot(s).  
NOTE: You can only use the Nano SIM2 card or the MicroSD card at a time.

Side features

- Microphone
- Audio jack
- Nano SIM1, Nano SIM2
- Volume key
- MicroSD combo card slot
- Power key
- Speaker
- Microphone
- Micro USB port

NOTES:

The Nano SIM card slots support LTE, WCDMA and GSM/EDGE network bands.

The microSD card slot supports microSD and microSDXC card formats.

3. Push the tray to close it

IMPORTANT: When two SIM cards are inserted, only one SIM card slot supports 4G/3G/2G service. The other SIM card slot only supports 2G service.

CAUTION!

Do not use sharp tools or solvent on your device to avoid scratches on it.

Use only a standard Nano SIM card on your

First Edition/ January 2017

Model: ASUS\_A007 (ZB501KL)

Before you start, ensure that you have read all the safety information and operating instructions in this User Guide to prevent injury or damage to your device.

NOTE: For the latest updates and more detailed information, please visit [www.asus.com](http://www.asus.com).

Front features

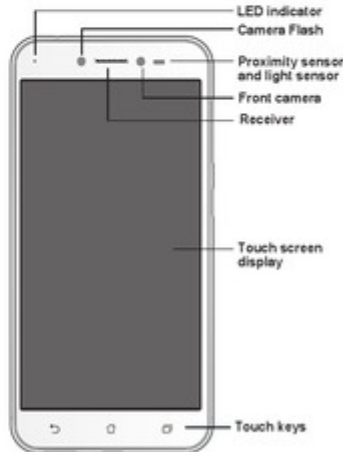

Installing a Nano SIM /MicroSD card

To install a Nano SIM / MicroSD card:

1. Push a pin into the hole on the Nano SIM / MicroSD card tray to eject it.



2. Insert the Nano SIM or MicroSD card(s) into the card slot(s).

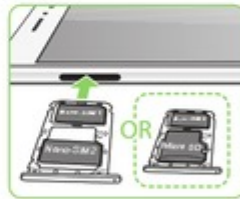

IMPORTANT: You can only use the Nano SIM2 card or the MicroSD card at a time.

Side features

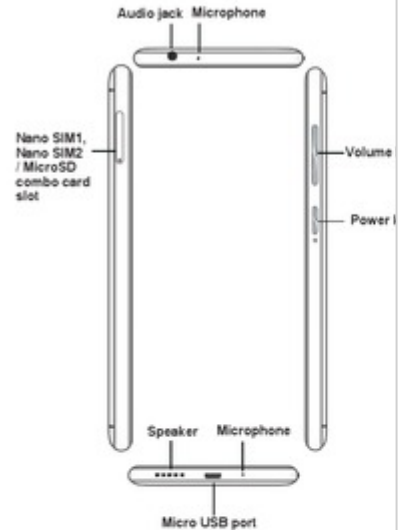

NOTES:

- The Nano SIM card slots support LTE, WCDMA and GSM/EDGE network bands.
- The microSD card slot supports microSD and microSDXC card formats.

3. Push the tray to close it



IMPORTANT: When two SIM cards are inserted, only one SIM card slot supports 4G/3G/2G service. The other SIM card slot only supports 2G service.

CAUTION!

- Do not use sharp tools or solvent on your device to avoid scratches on it.
- Use only a standard Nano SIM card on your ASUS Phone.

First Edition/ January 2017

Model: ASUS\_A007 (ZB501KL)

Side features

Audio jack Microphone

ASUS Phone.

Rear features

Rear camera  
Camera flash  
Rear cover

CE RF Exposure Compliance

This device meets the EU requirements (1999/519/EC) on the limitation of exposure of the general public to electromagnetic fields by way of health protection.  
For body-worn operation, this device has been tested and meets the ICNIRP guidelines and the European Standard EN 62209-2, for use with dedicated accessories. SAR is measured with this device at a separation of 0.5 cm to the body, while transmitting at the highest certified output power level in all frequency bands of this device. Use of other accessories which contain metals may not ensure compliance with ICNIRP exposure guidelines.

CE Mark Warning

CE marking for devices with wireless LAN/ Bluetooth

This equipment complies with the requirements of Directive 1999/5/EC of the European Parliament and Commission from 9 March, 1999 governing Radio and Telecommunications Equipment and mutual recognition of conformity. The highest CE SAR values for the device are as follows:

- 0.51 W/kg@10g (Head)
- 1.58 W/kg@10g (Body)

First Edition/ January 2017

Model: ASUS\_A007 (ZB501KL)

Before you start, ensure that you have read all the safety information and operating instructions in this **User Guide** to prevent injury or damage to your device.

**NOTE:** For the latest updates and more detailed information, please visit [www.asus.com](http://www.asus.com).

Front features

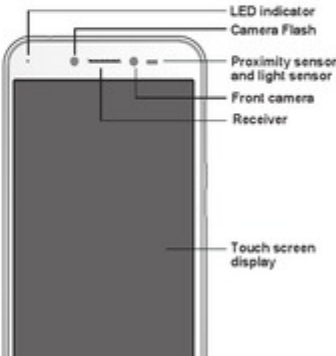

Side features

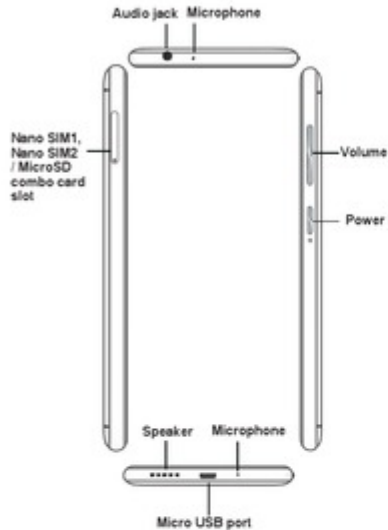

NOTES:

- The Nano SIM card slots support LTE, WCDMA and GSM/EDGE network bands.

[Next Page](#)

1  
2

## Related Manuals for Asus ZB501KL

[Smartphone Asus ZenFone Live User Manual](#)

(80 pages)

[Telephone Asus ZB553KL User Manual](#)

(106 pages)

[Cell Phone Asus zenfone go ZB452KG User Manual](#)

(102 pages)

[Cell Phone Asus X014D User Manual](#)

(20 pages)

[Cell Phone Asus ZENFONE GO ZB450KL User Manual](#)

(102 pages)

[Cell Phone Asus X00BD User Manual](#)

(23 pages)

[Cell Phone Asus Zenfone Go ZB500KG User Manual](#)

(106 pages)

[Cell Phone Asus X00ADC User Manual](#)

(2 pages)

[Cell Phone Asus Zenfone Go User Manual](#)

(86 pages)

[Cell Phone Asus ZenFone Max Pro ZB601KL User Manual](#)

(73 pages)

[Cell Phone Asus Zenfone Max Plus M1 User Manual](#)

(103 pages)

[Cell Phone Asus ZB602KL User Manual](#)

(74 pages)

[Cell Phone Asus Zenfone Max M2 User Manual](#)

(76 pages)

[Cell Phone Asus Zenfone Max pro M2 User Manual](#)

(75 pages)

[Cell Phone Asus Zenfone Max ZB555KL User Manual](#)

(92 pages)

[Cell Phone Asus Max Pro ZB630KL User Manual](#)

(72 pages)

## Summary of Contents for Asus ZB501KL

### [Page 1: User Guide](#)

CE RF Exposure Compliance Push the tray to close it To install a Nano SIM / MicroSD card: To charge your ASUS Phone: This device meets the EU requirements (1999/519/ EC) on the limitation of exposure of the general Connect the USB connector into the power public to electromagnetic fields by way of health adapter's USB port.

### [Page 2: Proper Disposal](#)

Fax: 886228907698 Support: <http://vip.asus.com/eservice/techserv.aspx> Copyright © 2017 ASUSTeK COMPUTER INC. All Rights Reserved. You acknowledge that all rights of this Manual remain with ASUS. Any and all rights, including without limitation, in the Manual or website, and shall remain the exclusive property of ASUS and/or its licensors. Nothing in this Manual intends to transfer any such rights, or to vest any such rights to you.

This manual is also suitable for:

Zenfone live