

Insulating The Refrigerant Tubing - Sanyo SPW-XR254EH56 Installation And Operation Manual

Dc inverter air conditioner

1

2

3

Table Of Contents

4

5

6

7

8

9

10

11

12

13

14

15

16

17

18
19
20
21
22
23
24
25
26
27
28
29
30
31
32
33
34
35
36
37
38
39
40

•

[Table of Contents](#)

•

Bookmarks



G

Do not use a spanner to tighten the valve stem caps. Doing so may damage the valves.

G

Depending on the installation conditions, applying excessive torque may cause the nuts to crack.

Precautions for Packed Valve Operation

G

If the packed valve is left for a long time with the valve stem cap removed, refrigerant will leak from the valve. Therefore, do not leave the valve stem cap removed.

G

Use a torque wrench to securely tighten the valve

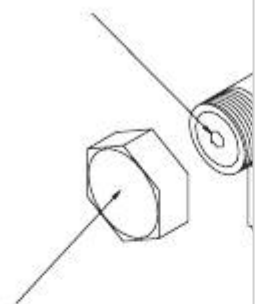

stem cap.

G

Valve stem cap tightening torque:.

Charging port

8 - 10 Nm (80 - 100 kgfcm)

9,52 mm (Narrow side)

19 - 21 N m (190 - 210 kgf cm)

15,88 mm (Wide side))

28 - 32 N m (280 - 320 kgf cm)

4-3. Insulating the Refrigerant Tubing

Tubing Insulation

G

Thermal insulation must be applied to all unit tubing, including distribution joint (purchased separately).

* For gas tubing, the insulation material must be heat resistant to 120°C or above. For other tubing, it must be heat resistant to 80°C or above.

Insulation material thickness must be 10 mm or greater.

If the conditions inside the ceiling exceed DB 30°C and RH 70%, increase the thickness of the gas tubing insulation material by 1 step.

CAUTION

Taping the flare nuts

Wind the white insulation tape around the flare nuts at the wide tube connections. Then cover up the tubing connections with the flare insulator, and fill the gap at the union with the supplied black insulation tape.

Finally, fasten the insulator at both ends with the supplied vinyl clamps. (Fig. 4-10)

Insulation material

The material used for insulation must have good insulation characteristics, be easy to use, be age resistant, and must not easily absorb moisture.

CAUTION

If the exterior of the outdoor unit valves has been finished with a square duct covering, make sure you allow sufficient space to use the valves and to allow the panels to be attached and removed.

After a tube has been insulated, never try to bend it



**into a narrow curve
because it can cause the
tube to break or crack.**

Packed valve
Valve stem
Valve stem cap

Two tubes arranged together

Inter-unit
control wiring
Sealer (supplied)
Unit side
insulator
Flare nut
Drain insulator
and clamp.

Large
(supplied)
Packing
clamp.

Small hose band (supplied)	
----------------------------------	--

**Never grasp the drain or refrigerant connecting
outlets when moving the unit.**

19

Charging port
Main valve

Fig. 4-8

Wide tube
Narrow tube
Armoring tape
Insulation

Fig. 4-9

Insulation tape (white)
(supplied)
Flare insulator (supplied)
Tube insulator
(not supplied)
Heat resistant
120°C or above
Vinyl clamps (supplied)

Fig. 4-10

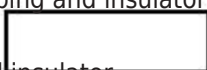
Refrigerant tubing and insulator
(not supplied) 
Drain pipe and insulator
(not supplied)
Insulation
tape
Vinyl
Flare
clamp

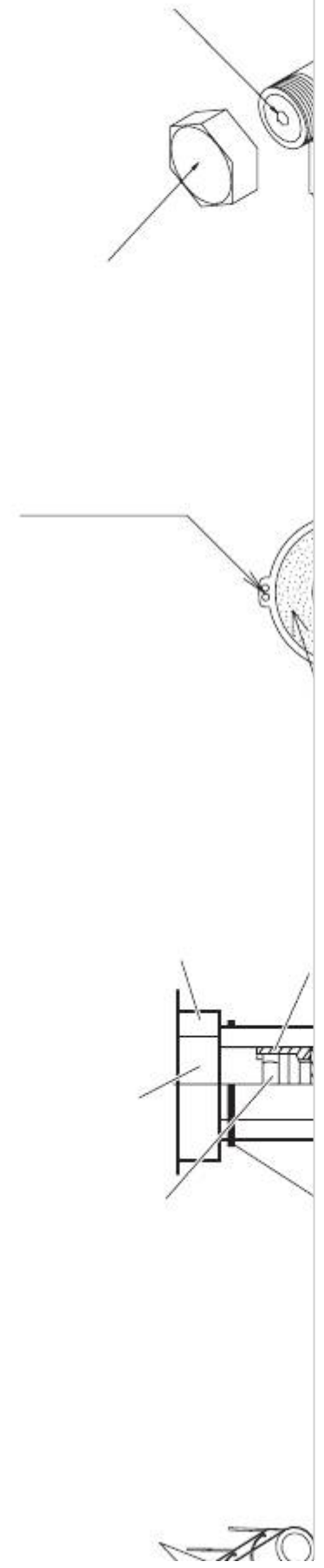

insulator

Seal

The procedure used for installing the insulator for both wide and narrow tubes is the same.

Fig. 4-11

[Table of Contents](#)

[Previous Page](#)
[Next Page](#)

1
...
16
17
18
19
20
21
22
23

Related Manuals for Sanyo SPW-XR254EH56

[Air Conditioner Sanyo SPW-X253GH56 Service Manual](#)

Split system (105 pages)

[Air Conditioner Sanyo SPW-X483GH56 Installation Instruction](#)

Eco multi system air conditioner (91 pages)

[Air Conditioner Sanyo SPW-C256VH Technical Data & Service Manual](#)

4-way air discharge semi-concealed wall-mounted ceiling-mounted concealed-duct (517 pages)

[Air Conditioner Sanyo Big PACi 18 Series Technical Data & Service Manual](#)

Big pack i dc inverter (275 pages)

[Air Conditioner Sanyo SPW-X253G56 Service Manual](#)

Split system (72 pages)

[Air Conditioner Sanyo SPW-XR253GH56 Technical Data & Service Manual](#)

(223 pages)

[Air Conditioner Sanyo 2-WAY ECO-i SPW-C0705DXHN8 Service Manual](#)

Multi system (143 pages)

[Air Conditioner Sanyo Mini ECO-i SPW-ASR74GXH56\(A/B\) Installation Instructions Manual](#)

System air conditioner (49 pages)

[Air Conditioner Sanyo SPW-K075XH Specification Sheet](#)

M series gas heat pump air conditioner (76 pages)

[Air Conditioner Sanyo ECO G SGP-EGW190M2G2W Brochure & Specs](#)

Gas driven vrf m series (9 pages)

[Air Conditioner Sanyo SPW-C1155DXHN8 Technical Data & Service Manual](#)

2-way eco-i multi system (242 pages)

[Air Conditioner Sanyo MINI ECO-i SPW-CR365GXH56B Service Manual](#)

(252 pages)

[Air Conditioner Sanyo SPW-CR365GXH56 Technical Data Manual](#)

Mini eco-i system (346 pages)

[Air Conditioner Sanyo SPW-T253GH56 Service Manual](#)

Split system (106 pages)

[Air Conditioner Sanyo SPW-CR1503GDYH8 Technical Data & Service Manual](#)

W-eco multi system series (377 pages)

[Air Conditioner Sanyo SPW-CR363GVH8 Service Manual](#)

(262 pages)

Related Content for Sanyo SPW-XR254EH56

[W-3WAY ECO-i 85464369098000 Insulating The Refrigerant Tubing](#)

Sanyo W-3WAY ECO-i 85464369098000

[Mini ECO-i 85464359981002 Insulating The Refrigerant Tubing](#)

Sanyo Mini ECO-i 85464359981002

[PW-UMR184EXH56 Insulating The Refrigerant Tubing](#)

Sanyo PW-UMR184EXH56

[PNR-XS2432 Insulating The Refrigerant Tubing](#)

Sanyo PNR-XS2432

[ECO R410A Insulating The Refrigerant Tubing](#)

Sanyo ECO R410A

[C4272R S/C Insulating The Refrigerant Tubing](#)

Sanyo C4272R S/C

[85464359982001 Insulating The Refrigerant Tubing](#)

Sanyo 85464359982001

[SAP-CMRV1426EH Insulation Of Refrigerant Tubing](#)

Sanyo SAP-CMRV1426EH

This manual is also suitable for:

[Spw-xr364eh56Spw-xr484eh56](#)