



Sanyo DP42746 Quick And Easy Setup

Sanyo dp42746: quick start

1
2

| |
|--|
| |
|--|

•

Bookmarks

Quick Links

[Download this manual](#) See also: [Service Manual](#), [Owner's Manual](#)

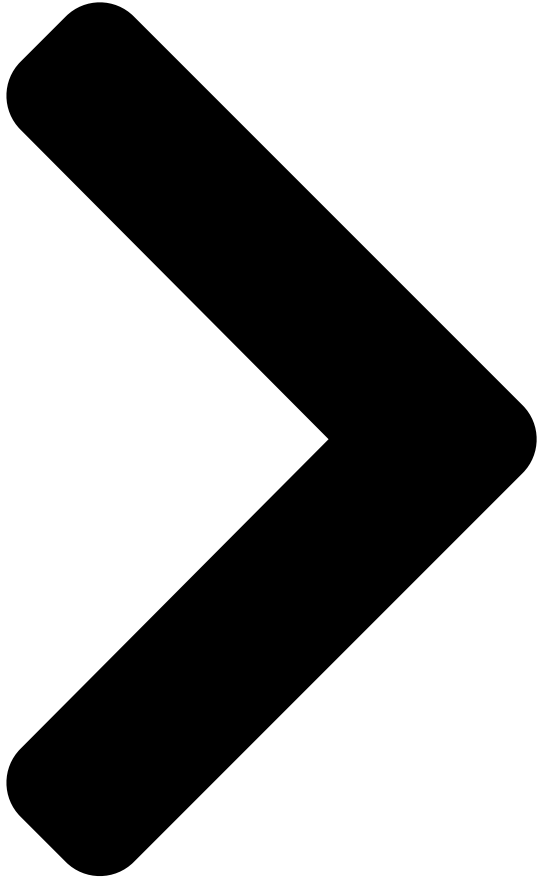

HIGH-DEFINITION TELEVISION

Quik 'N Easy Setup

1st Quik 'N Easy Setup

1st CONNECT ANTENNAS

CONNECT ANTENNAS

CONNECT DIGITAL ANTENNA

2nd SEARCH FOR AVAILABLE CHANNELS

BEGIN CHANNEL SEARCH

CONNECT DIGITAL ANTENNA

Don't be fooled by the phrase "Available in High-Definition." To receive your local Digital channels in stunning High-Definition, you must connect an antenna to the Digital Antenna In terminal.

Other digital signals can be received from a set-top box (STB) through the VIDEO 2 VIDEO 3 and HDMI jacks (see Quik Step 3 below). The signal makes the difference. Connect an antenna or your analog cable system to the UHF/VHF/CATV terminal to receive analog channels.

DIGITAL ANTENNA IN
Antenna
Antenna
DIGITAL ANTENNA IN
or
Cable
Part Number: 1JC6P1P0230--

1st CONNECT ANTENNAS

CONNECT DIGITAL ANTENNA

Don't be fooled by the phrase "Available in High-Definition." To receive your local Digital channels in stunning High-Definition, you must connect an antenna to the Digital Antenna In terminal.

Other digital signals can be received from a set-top box (STB) through the VIDEO 2 VIDEO 3 and HDMI jacks (see Quik Step 3 below). The signal makes the difference.

Don't be fooled by the phrase "Available in High-Definition." To watch Satellite or Digital Cable HD programs in High-Definition, you must:

1. Subscribe to Satellite or Digital Cable High-Definition service.
2. Connect your Satellite or Cable HD Receiver to the Component or HDMI input jacks on the DTV.

Crucial Advice for Best Picture Composite and RF output signals from set-top boxes are Analog. These jacks are for compatibility to older analog equipment, such as, a VCR.

1. DO NOT connect your HD Satellite receiver, HD Cable Box receiver, or DVD player to the Composite input jacks (VIDEO 1)

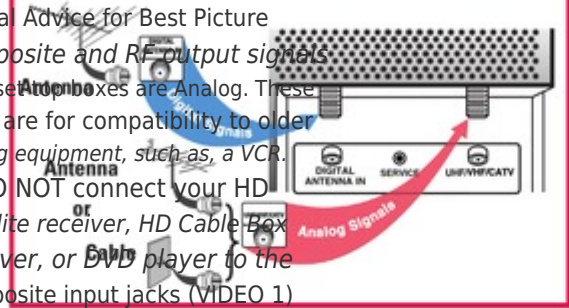

on the Part Number: 1JC6P1P0230--

Component
AV OUT
HDMI
VIDEO 1
VIDEO 2
VIDEO 3
VIDEO 4
VIDEO 5
VIDEO 6
VIDEO 7
VIDEO 8
VIDEO 9
VIDEO 10
VIDEO 11
VIDEO 12
VIDEO 13
VIDEO 14
VIDEO 15
VIDEO 16
VIDEO 17
VIDEO 18
VIDEO 19
VIDEO 20
VIDEO 21
VIDEO 22
VIDEO 23
VIDEO 24
VIDEO 25
VIDEO 26
VIDEO 27
VIDEO 28
VIDEO 29
VIDEO 30
VIDEO 31
VIDEO 32
VIDEO 33
VIDEO 34
VIDEO 35
VIDEO 36
VIDEO 37
VIDEO 38
VIDEO 39
VIDEO 40
VIDEO 41
VIDEO 42
VIDEO 43
VIDEO 44
VIDEO 45
VIDEO 46
VIDEO 47
VIDEO 48
VIDEO 49
VIDEO 50
VIDEO 51
VIDEO 52
VIDEO 53
VIDEO 54
VIDEO 55
VIDEO 56
VIDEO 57
VIDEO 58
VIDEO 59
VIDEO 60
VIDEO 61
VIDEO 62
VIDEO 63
VIDEO 64
VIDEO 65
VIDEO 66
VIDEO 67
VIDEO 68
VIDEO 69
VIDEO 70
VIDEO 71
VIDEO 72
VIDEO 73
VIDEO 74
VIDEO 75
VIDEO 76
VIDEO 77
VIDEO 78
VIDEO 79
VIDEO 80
VIDEO 81
VIDEO 82
VIDEO 83
VIDEO 84
VIDEO 85
VIDEO 86
VIDEO 87
VIDEO 88
VIDEO 89
VIDEO 90
VIDEO 91
VIDEO 92
VIDEO 93
VIDEO 94
VIDEO 95
VIDEO 96
VIDEO 97
VIDEO 98
VIDEO 99
VIDEO 100

3rd DVD PLAYER AND OTHER CRUCIAL DIGITAL EQUIPMENT AUDIO VIDEO CONNECT

2 BEFORE YOU MAKE ANY AV CONNECTIONS... THE SIGNAL MAKES THE DIFFERENCE

Don't be fooled by the phrase "Available in High-Definition." To watch Satellite or Digital Cable HD programs in High-Definition, you must:

1. Subscribe to Satellite or Digital Cable High-Definition service.
2. Connect your Satellite or Cable HD Receiver to the Component or

2nd SEARCH FOR AVAILABLE CHANNELS

BEGIN CHANNEL SEARCH

Channel Search Note

Before starting All Channel Search, point your antenna(s) toward the transmitting tower(s). (Log onto www.antennaweb.org, then type in your street address and zip code to view a list of your local channels and the type of antenna that is necessary to receive them. Click on "View Street Level Map" to see a map and graph of the transmitting towers in your area.)

The channel search process may take a few minutes. Watch be patient.

Skip Channel Search Option

If you receive your local channels from a Satellite or Cable Box connection, or you intend only to watch videos or to play video games on this DTV, press the EXIT key to skip the Channel Search process.

Then press the INPUT key on the remote control to select the AV signal source: Video 1, Video 2, Video 3, or HDMI. See Quik Step 3 below.

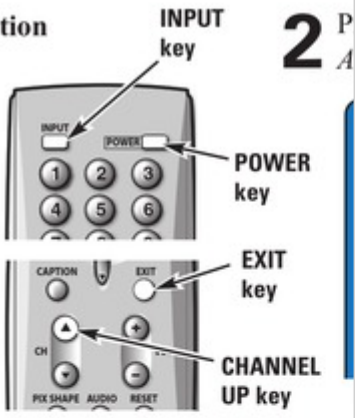

DVD PLAYER CONNECTION THE SIGNAL MAKES THE DIFFERENCE

The Component jacks on this SDTV receive video signals, making connecting your DVD player. Because there are two sets of

nd

BEGIN CHANNEL SEARCH

Channel Search Note

Before starting All Channel Search, point your antenna(s) toward the transmitting tower(s). (Log onto www.antennaweb.org, then type in your street address and zip code to view a list of your local channels and the type of antenna that is necessary to receive them. Click on "View Street Level Map" to see a map and graph of the transmitting towers in your area.)

The channel search process may take a few minutes. Please be patient.

Skip Channel Search Option

If you receive your local channels from a Satellite or Cable Box connection, or you intend only to watch videos or to play video games on this DTV, press the EXIT key to skip the Channel Search process.

Then press the INPUT key on

the remote control to select the AV signal source: Video 1, Video 2, Video 3, or HDMI.

See Quik Step 3 below.

Don't be fooled by the phrase "Available in High-Definition." To receive your local digital channels in stunning High-Definition, you must connect an antenna to the Digital Antenna In terminal.

Other digital signals can be received from a set-top box (STB) through the VIDEO 2, VIDEO 3, and HDMI Jacks (see Quik Step 3 below). The signal makes the difference.

DO NOT Connect Your HD Receiver or DVD Player to the Component or S-Video outputs of a High-Definition receiver. (Satellite or Cable Box) to either DTV RF input terminal.

To view the highest resolution your Digital AV set-top box or DVD player can reproduce, you must connect it to the VIDEO 2, VIDEO 3, or HDMI inputs.

NOTE: Refer to the owner's manual for HDMI connection instructions



Quik 'N Easy Setup

1st CONNECT ANTENNAS

CONNECT DIGITAL ANTENNA

Don't be fooled by the phrase "Available in High-Definition." To receive your local digital channels in stunning High-Definition, you must connect an antenna to the Digital Antenna In terminal.

Other digital signals can be received from a set-top box (STB) through the VIDEO 2, VIDEO 3, and HDMI Jacks (see Quik Step 3 below). The signal makes the difference.

DO NOT Connect Your HD Receiver or DVD Player to the Component or S-Video outputs of a High-Definition receiver. (Satellite or Cable Box) to either DTV RF input terminal.

To view the highest resolution your Digital AV set-top box or DVD player can reproduce, you must connect it to the VIDEO 2, VIDEO 3, or HDMI inputs.

NOTE: Refer to the owner's manual for HDMI connection instructions

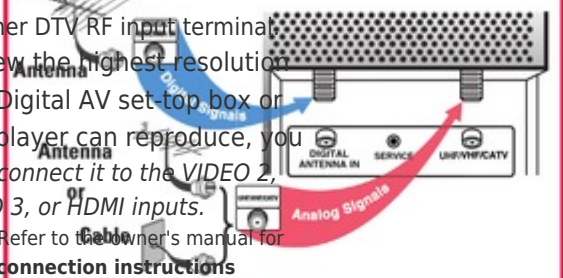

2nd SEARCH FOR AVAILABLE CHANNELS

BEGIN CHANNEL SEARCH

Channel Search Note

Before starting All Channel Search, point your antenna(s) toward the transmitting tower(s). (Log onto www.antennaweb.org, then type in your street address and zip code to view a list of your local channels and the type of antenna that is necessary to receive them. Click on "View Street Level Map" to see a map and graph of the transmitting towers in your area.)

The channel search process may take a few minutes. Please be patient.

Skip Channel Search Option

If you receive your local channels from a Satellite or Cable Box connection, or you intend only to watch videos or to play video games on this DTV, press the EXIT key to skip the Channel Search process.

Then press the INPUT key on the remote control to select the AV signal source: Video 1, Video 2, Video 3, or HDMI. See Quik Step 3 below.

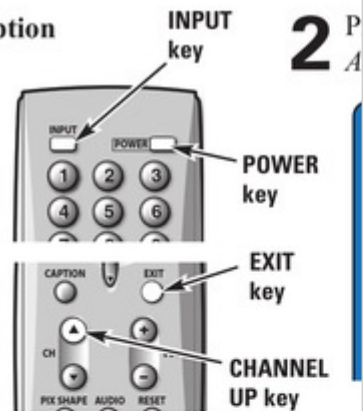

SEARCH FOR AVAILABLE CHANNELS

3rd DVD PLAYER AND OTHER CRUCIAL DIGITAL EQUIPMENT AUDIO VIDEO CONNECT

BEFORE YOU MAKE ANY AV CONNECTIONS... THE SIGNAL MAKES THE DIFFERENCE

Don't be fooled by the phrase "Available in High-Definition." To watch Satellite or Digital Cable HD programs in High-Definition, you must:

- 1. Subscribe to Satellite or Digital Cable High-Definition service.
2. Connect your Satellite or Cable HD Receiver to the Component or

DVD PLAYER CONNECTION THE SIGNAL MAKES THE DIFFERENCE

The Component jacks on this SDTV video signals, making connecting your DVD player.

Because there are two sets of co

INPUT key
INPUT POWER
1
1
1
2
2
3
3
4
5
6
4
5
6
7
7
8

8
9
9
CAPTION
EXIT
M
CH
VOL
PIX SHAPE
AUDIO
RESET



Quik'N Easy Setup

DVD PLAYER CONNECTION

THE SIGNAL MAKES THE DIFFERENCE

The Component jacks on this DTV will accept HDTV, EDTV, or SDTV video signals, making Component a great choice when connecting your DVD player.

Because there are two sets of component jacks, you have the option of connecting a second digital device, such as a Digital Cable Box or Satellite Receiver.

NOTE: A subscription to Digital Cable service or Satellite service is required for those connections. The subscription must include High-Definition programming and you must connect an HD Receiver to your DTV to view HD images.

Connecting a DVD Player

CONNECT DIGITAL ANTENNA (VIDEO 2 or VIDEO 3)

1

Don't be fooled by the phrase "Available in High-Definition." To receive your local Digital channels in stunning High-Definition, you must connect an antenna to the Digital Antenna In terminal.

Simply connect a Component cable to a set of Green, Blue, and Red Video Jacks on the DTV and to a DVD player, as shown. (Cable is not supplied.)

2

Other digital signals can be received from a set-top box (STB), through the VIDEO 2, VIDEO 3 and HDMI Jacks (see Quik Step 3 below). The signal makes the difference. Connect an antenna or your analog cable system to the UHF/VHF/CATV terminal to receive analog channels.

Then connect an Audio cable to the matching set of White and Red Audio Jacks, as shown, and to the DVD player. (Cable is not supplied.)

3

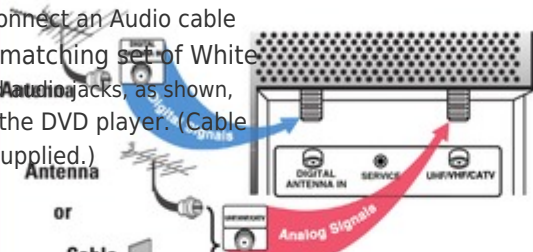

Use the INPUT key on the remote control to select Video 2 or Video 3. (See Skip Channel Search Option under Quik Step 2 above.)

3rd DVD PLAYER AND OTHER CRUCIAL DIGITAL EQUIPMENT AUDIO VIDEO CONNECT

AS

BEFORE YOU MAKE ANY AV CONNECTIONS...

THE SIGNAL MAKES THE DIFFERENCE

Call Us, We Can Help!

1-800-877-5032

www.sanyodtv.com

Press the POWER key.

Don't be fooled by the phrase "Available in High-Definition." To watch Satellite or Digital Cable HD programs in High-Definition, you must: 1. Subscribe to Satellite or Digital Cable High-Definition service. 2. Connect your Satellite or Cable HD Receiver to the Component or

2nd SEARCH FOR AVAILABLE CHANNELS

BEGIN CHANNEL SEARCH

1 P

Channel Search Note

Before starting All Channel Search, point your antenna(s) toward the transmitting tower(s). (Log onto www.antennaweb.org, then type in your street address and zip code to view a list of your local channels and the type of antenna that is necessary to receive them. Click on "View Street Level Map" to see a map and graph of the transmitting towers in your area.)

The channel search process may take a few minutes. Please be patient.

Skip Channel Search Option

If you receive your local channels from a Satellite or Cable Box connection, or you intend only to watch videos or to play video games on this DTV, press the EXIT key to skip the Channel Search process.

Then press the INPUT key on the remote control to select the AV signal source: Video 1, Video 2, Video 3, or HDMI. See Quik Step 3 below.

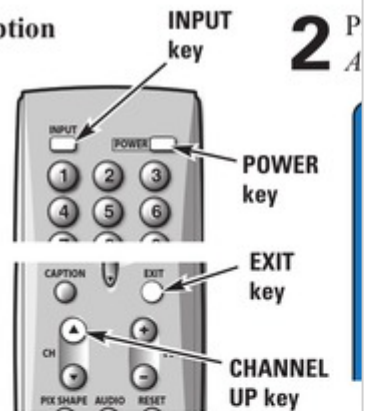

2 P A

DVD PLAYER CONNECTION

THE SIGNAL MAKES THE DIFFERENCE

The Component jacks on this DTV will accept HDTV, EDTV, or SDTV video signals, making Component a great choice when connecting your DVD player.

Because there are two sets of component jacks, you have the option of connecting a second digital device, such as a Digital Cable Box or Satellite Receiver.

1 HDTV

First
Please connect all signals and antennas to jacks and terminals on the back of the TV.
Then press the Channel UP key.
Press EXIT key to cancel setup.
Initial On-Screen Display
Press the CH+ channel up key to start

Quik 'N Easy Setup

All Channel Search.

POWER

No input signal sources could be located.
key

Please check cable or antenna connections.

EXIT

Then press the Channel UP key.

key

CHANNEL

UP key

No Signal Detected - Press CHANNEL UP Again

(most common method)

DVD Player

(or Satellite receiver, Digital

Cable box, Video must connect an antenna to the Digital

Antenna In terminal.

Other digital signals can be received from a

set-top box (STB) through the VIDEO 2,

VIDEO 3, and HDMI Jacks (see Quik Step 3

below). *The signal makes the difference.*

Connect an antenna or your analog cable system to the

UHF/VHF/CATV terminal to receive analog channels.

DTV Back

VIDEO 1 VIDEO 2 VIDEO 3

Y

S-VIDEO

Pb

Pd

SERVICE

V

Pr

Pr

AUDIO

OUTPUT

L

L

R

R

R

R

R

R

R

R

R

R

R

R

R

R

R

R

R

R

R

R

R

R

R

R

R

R

R

R

1st CONNECT ANTENNAS

CONNECT DIGITAL ANTENNA

Don't be fooled by the phrase "Available in High-Definition." To receive your local Digital channels in stunning High-Definition, you must connect an antenna to the Digital Antenna In terminal.

Other digital signals can be received from a set-top box (STB) through the VIDEO 2, VIDEO 3, and HDMI Jacks (see Quik Step 3 below). *The signal makes the difference.*

Connect an antenna or your analog cable system to the UHF/VHF/CATV terminal to receive analog channels.

The diagram shows the back of the DTV with three main connection points: 'DIGITAL ANTENNA IN', 'SERVICE', and 'UHF/VHF/CATV'. A blue arrow points from an antenna to the 'DIGITAL ANTENNA IN' terminal. A red arrow points from a cable box to the 'SERVICE' terminal. A red arrow points from a cable to the 'UHF/VHF/CATV' terminal. Labels 'Antenna', 'Cable', and 'Analog Signals' are placed near their respective connection points.

NOTE: This DTV has two identical sets of Component AV jacks (VIDEO 2 & VIDEO 3), use either set (or both sets) when connecting digital AV equipment.

2nd SEARCH FOR AVAILABLE CHANNELS

BEGIN CHANNEL SEARCH

Channel Search Note

Before starting *All Channel Search*, point your antenna(s) toward the transmitting tower(s). (Log onto www.antennaweb.org, then type in your street address and zip code to view a list of your local channels and the type of antenna that is necessary to receive them. Click on "View Street Level Map" to see a map and graph of the transmitting towers in your area.)

The channel search process may take a few minutes. Please be patient.

Skip Channel Search Option

If you receive your local channels from a Satellite or Cable Box connection, or you intend *only* to watch videos or to play video games on this DTV, press the **EXIT** key to skip the Channel Search process.

Then press the **INPUT** key on the remote control to select the AV signal source: Video 1, Video 2, Video 3, or HDMI. See Quik Step 3 below.

The diagram shows a remote control with four keys highlighted: 'INPUT' (top left), 'POWER' (top right), 'EXIT' (middle right), and 'CHANNEL UP' (bottom left). Arrows point from the text labels to these specific keys.

[Next Page](#)

1

2

Related Manuals for Sanyo DP42746

[Plasma TV Sanyo DP42746 Owner's Manual](#)

(59 pages)

[Plasma TV Sanyo DP42746 Service Manual](#)

Remote control plasma color television (38 pages)

[TV Sanyo DP42746 Connection Manual](#)

Sanyo dp42746: connection guide (3 pages)

[TV Sanyo P46841-03 Service Manual](#)

Remote control digital color televisio (48 pages)

[TV Sanyo DP42840 Service Manual](#)

(47 pages)

[TV Sanyo DP42840 Service Manual](#)

Remote control digital color television chassis no. p42840-05 (43 pages)

[TV Sanyo DP46840 Service Manual](#)

(47 pages)

[TV Sanyo DP26649 Service Manual](#)

Remote control digital color television (46 pages)

[TV Sanyo DP42849 Service Manual](#)

Remote control digital color television (43 pages)

[TV Sanyo DP46142 Manual Del Propietario](#)

Hdtv lcd de 720p/1080p (28 pages)

[TV Sanyo DP46848 Service Manual](#)

Remote control digital color television (58 pages)

[TV Sanyo DP42142 Service Manual](#)

Remote control digital (52 pages)

[TV Sanyo DP42D23 Owner's Manual](#)

Led 42" 1080p hdtv lcd (2 pages)

[TV Sanyo DP46812 Owner's Manual](#)

1080p hdtv lcd 1080p hdtv lcd (2 pages)

[TV Sanyo DP47460 Service Manual](#)

Remote control digital color television (48 pages)

[TV Sanyo FVM4612 Service Manual](#)

(37 pages)

Summary of Contents for Sanyo DP42746

[Page 1: Dvd Player Connection](#)

Press the POWER key. First Please connect all signals and antennas to jacks and terminals on the back of the TV. Then press the Channel UP key. Press EXIT key to cancel setup. Initial On-Screen Display Press the CH L (channel up) key to start INPUT All Channel Search.

[Page 2: Positioning Precautions](#)

DTV. For best viewing, avoid locating the DTV where direct sunlight or indoor lighting falls on the screen. NOTE: The optimum viewing distance of your new Sanyo Wide Screen Plasma DTV is 8.75 feet. Allow adequate space for proper ventilation (3 to 4 inches on the sides, top, and back).