



# Rcs-Bh80Ua.wl; Separate Type Signal Receiving Unit Installation - Sanyo 26 series Installation Instructions Manual

Split system heat pump air conditioner



1

2

3

4

5

Table Of Contents

6

7

8

9

10

11

12

13

14

15

16

17

18  
19  
20  
21  
22  
23  
24  
25  
26  
27  
28  
29  
30  
31  
32  
33  
34  
35  
36  
37  
38  
39  
40  
41  
42  
43  
44  
45  
46  
47  
48  
49  
50  
51  
52  
53  
54  
55  
56  
57  
58  
59  
60  
61  
62  
63  
64  
65  
66  
67

68  
69  
70  
71  
72  
73  
74  
75  
76  
77  
78  
79  
80  
81  
82  
83  
84  
85  
86  
87  
88  
89  
90  
91  
92  
93  
94  
95  
96  
97  
98  
99  
100  
101  
102  
103  
104  
105  
106  
107  
108  
109  
110

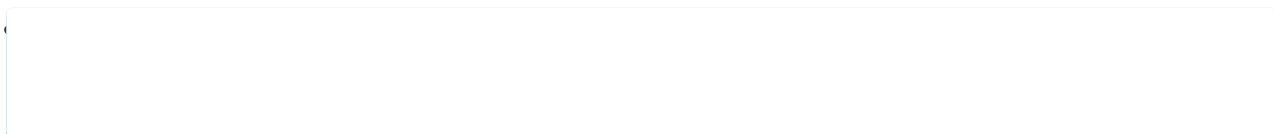

•

[Table of Contents](#)

•

## Bookmarks







<RCS-BH80UA.WL>

**CAUTION**

### **7-12. Separate Type Signal Receiving Unit Installation**

**CAUTION**



If local electrical codes allow, this signal receiving unit can be mounted using a conventional wall box for flush mounting.

- (1) Insert a standard screwdriver into the gap under the signal receiving unit and pry off the cover (Fig. 7-14)
- (2) Attach the signal receiving unit with the 2 small screws provided.

Use the spacers and take care not to tighten the screws excessively.

If the signal receiving unit will not seat well, cut the spacers to a suitable thickness. (Fig. 7-13)  
(3) Connect the signal receiving unit wiring (2 wires) correctly to the corresponding terminals in the electrical component box of the indoor unit.

**CAUTION**

**If the signal receiving unit is installed near a rapid-start or inverter type fluorescent lamp (neither one uses glow lamps), it may be impossible to receive signals from the wireless remote controller. To avoid signal interference from fluorescent lamps, install the receiving unit at least 6.6 ft. away from the lamps and install at a location where wireless remote controller signals can be received when the fluorescent lamps are on.**

**Do not twist the operating controller wires together with the power supply wires. Doing so can result in malfunction.**

**If electrical noise is induced in the unit power supply, take appropriate measures, for example installing a filter.**

**In wiring, do not connect the signal receiving unit to the adjacent terminal block for the power wiring. Otherwise, the unit will break down.**

Signal receiving unit  
M4 x L1 in  
Screws (2)

Notch

Cover plate

**Fig. 7-13**

**Fig. 7-14**

**74**

Spacer

Switch box (no cover)

ManualsLib.com

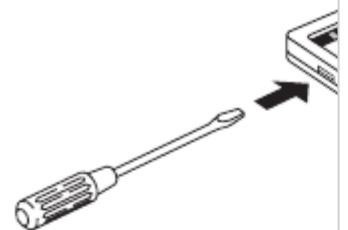

## Table of Contents

[Previous Page](#)  
[Next Page](#)

1  
...  
71  
72  
73  
74  
75  
76  
77  
78

Quick Links:

[Indoor Unit](#)

[Outdoor Unit](#)

[Trouble Diagnostics](#)

## Related Manuals for Sanyo 26 series

[Air Conditioner Sanyo Big PACi 18 Series Technical Data & Service Manual](#)

Big pack i dc inverter (275 pages)

[Air Conditioner Sanyo C4272R Service Manual](#)

Sanyo split system air conditioner service manual (181 pages)

[Air Conditioner Sanyo C4272R S/C Installation Instructions Manual](#)

Sanyo split system heat pump air conditioner installation instructions (111 pages)

[Air Conditioner Sanyo C3072R Parts List](#)

Outdoor unit (4 pages)

[Air Conditioner Sanyo CH3672R Parts List](#)

Outdoor unit (4 pages)

[Air Conditioner Sanyo 000-31 Specifications](#)

Concealed duct air conditioner & heat pump 24,000-31,200 btu/h 13.9-14.9 seer  
(2 pages)

[Air Conditioner Sanyo 26KS72R Specifications](#)

Wall mounted air conditioner (2 pages)

[Heat Pump Sanyo 26THW72R Specifications](#)

Ceiling suspended heat pump (2 pages)

[Air Conditioner Sanyo 26UW72R Specifications](#)

Concealed duct air conditioner (2 pages)

[Air Conditioner Sanyo 26KHS72R Submittal Data](#)

Wall mounted heat pump (2 pages)

[Air Conditioner Sanyo 36UW72R Specifications](#)

Concealed duct air conditioner (2 pages)

[Air Conditioner Sanyo KHHS2672R Specifications](#)

Wall mounted heat pump with heater (2 pages)

[Air Conditioner Sanyo KHS3072R Specifications](#)

Wall mounted air conditioner (2 pages)

[Air Conditioner Sanyo KHS3672R Datasheet](#)

Wall mounted air conditioner (2 pages)

[Air Conditioner Sanyo THW3672R Specifications](#)

Ceiling suspended air conditioner (2 pages)

[Air Conditioner Sanyo XHW2672R Specifications](#)

Ceiling recessed air conditioner (2 pages)

## Related Content for Sanyo 26 series